

# LFT SERIES

## RECESSED T-BAR FLUORESCENT

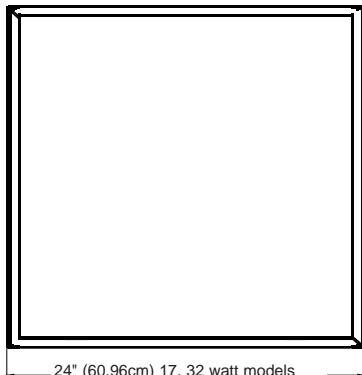

24" (60.96cm) 17, 32 watt models  
48" (121.92cm) 32, 40 watt models

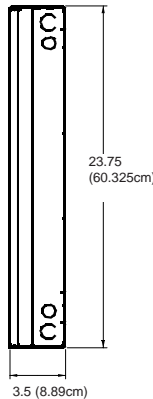

Weight: 2' Version = 14 lbs. (6.4 kg)  
4' Version = 18 lbs (8.2 kg)

**DESCRIPTION:** The *LFT Series* is an Interior T-Bar mounted fluorescent fixture used for below deck marine lighting and low ceiling applications where T-Bar mounting is required.

### SPECIFICATIONS

**Housing:** Corrosion-resistant, copper-free welded aluminum. Also available, cold rolled steel option.

**Finish:** Thermoset, white polyester powder coated finish.

**Lens Frame:** Drop-down frame has hinges for easy access. Fits inside marine type T-Bar ceilings.

**Diffuser:** Acrylic prismatic diffuser for controlled light.

**Gasketing:** Watertight EPDM gasket on access plate.

**Reflector:** Aluminum with high reflectance white powder coat finish.

**Hardware:** All hardware is captive; all exposed hardware is non-magnetic stainless steel.

**Ballast:** 120 volt, 60 Hz high power factor ballast standard. Contact factory for alternative voltages.

**Wiring:** Pre-wired phenolic terminal block located on the access plate is standard for easy wiring.

**Lamp Holder:** Twist and lock lamp holders to protect lamps during shock or vibration.

### OPTIONS

- Emergency Ballast
- Low Temperature Ballast
- Radio Frequency Filter

### COMPLIANCES

**UL Listed:**

**Standard Units:**

**UL 1598A - Marine Inside Drip-proof Type**

**UL924 - Emergency Ballast**

**Meets US Coast Guard Requirements**

**cUL Listed for use in Canada**

**ABS**



N-5610282D

**PHOENIX®**

# PHOTOMETRICS

Contact Phoenix Products Company for Photometric information.  
Or visit our Website at [www.phoenixproducts.com](http://www.phoenixproducts.com)

## ORDERING INFORMATION

\*\*\* PLEASE NOTE NOT ALL COMBINATIONS LISTED BELOW ARE AVAILABLE. CONTACT FACTORY WITH ANY QUESTIONS

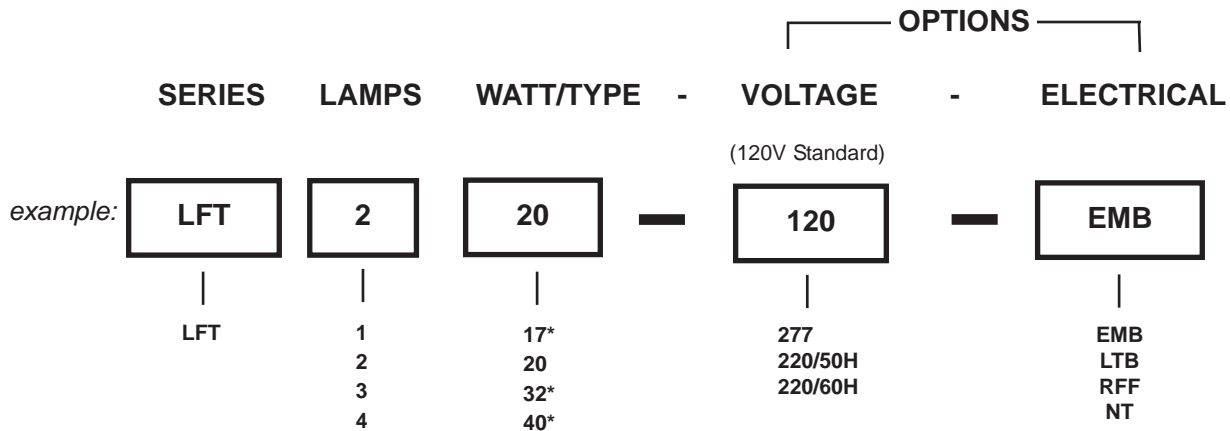

### WATT/TYPE

17\* = F17 T-8 (Medium Bi-Pin, 2')  
20 = F20 T-12 (Medium Bi-Pin, 2')  
32\* = F32 T-8 (Medium Bi-Pin, 4')  
40\* = F40T12 (Medium Bi-Pin, 4')

Lamps not Included

### VOLTAGE OPTIONS

120V  
277V  
220/50H = 220 Volt; 50Hz  
220/60H = 220 Volt; 60Hz

### ELECTRICAL OPTIONS

EMB = Emergency Ballast  
LTB = Low Temperature Ballast  
RFF = Radio Frequency Filter  
NT = No Terminal

\*Electronic Ballast is Standard

N-5610282D

# PHOENIX®