

# LFCN SERIES

## MARINE CORNICE LIGHT

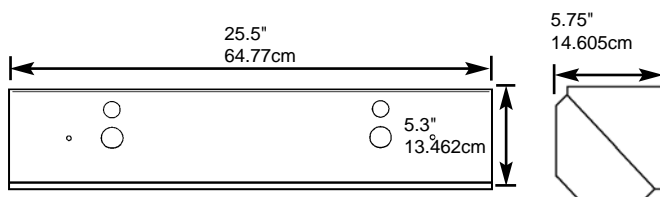

Weight: 8.1 lbs. (3.674kg)

**DESCRIPTION:** The *LFCN Series* is a corner-mount, ceiling/passageway fixture used in vessel and rig lighting where surface mounting is desired. The corner mounting minimizes obstruction to the passageway.

### SPECIFICATIONS

**Housing:** Corrosion resistant, Marine grade low copper content aluminum alloy.

**Finish:** Thermoset, white polyester powder-coated finish.

**Lens:** White translucent acrylic or optional clear polycarbonate.

**Gasketing:** EPDM rubber gasket provides a positive seal against dirt and moisture.

**Reflector:** White polyester powder-coated finish on aluminum reflector surface for maximum light output.

**Hardware:** Stainless steel captive thumbscrews secure the diffuser for ease of maintenance.

**Terminal Block:** Supply connections are made to include fixture terminal block for ease of installation. Standard on all fixtures.

**Ballast:** 120 volt, 60 Hz high power factor ballast standard.

### OPTIONS

- Convenience Outlet
- Power Switch
- Electronic Ballast (standard on 17, 50 and 55W fixtures)
- Radio Frequency Interference Filter
- Clear Polycarbonate Diffuser
- Emergency Ballast

### COMPLIANCES

UL 1598A Listed - Inside Type  
UL 1598 Indoor Listed - US & Canada



N-5610283D

**PHOENIX®**

# PHOTOMETRICS

Contact Phoenix Products Company for Photometric Information  
or visit our Website at [www.phoenixproducts.com](http://www.phoenixproducts.com)

## ORDERING INFORMATION

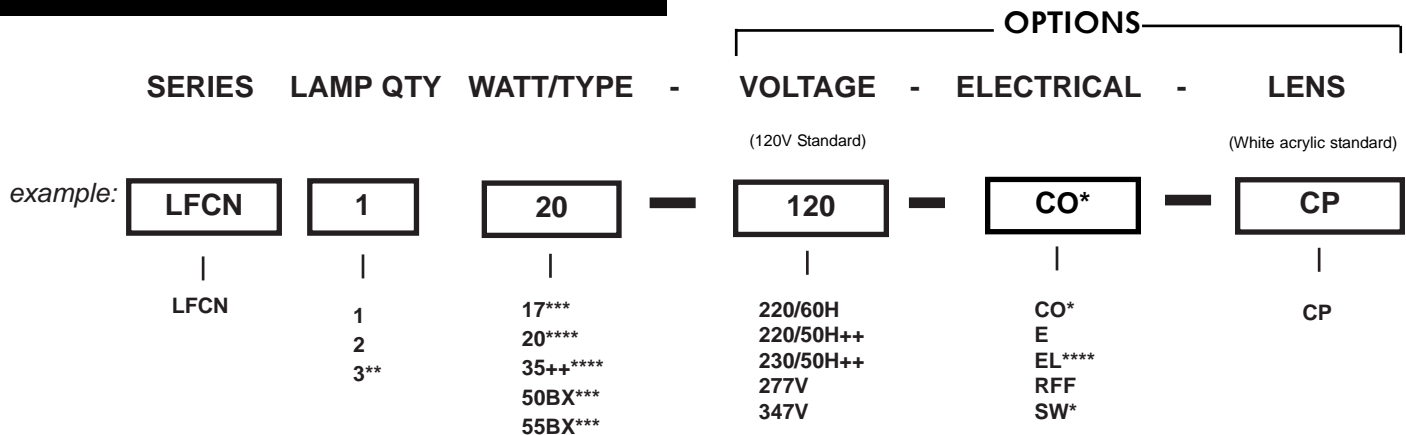

Terminal Block Standard on All Fixtures.

### Lamps Not Included

#### WATT/TYPE

17 = F17 T-8 (Med Bi-Pin)\*\*\*  
 20 = F20 T-12 (Med Bi-Pin)\*\*\*\*  
 35 = F24 T-12/HO (RDC)\*\*\*\*  
 50BX = F50BX (2G11)\*\*\*  
 55BX = F55BX (2G11)\*\*\*

#### VOLTAGE OPTIONS

220/50Hz = 220 Volt  
 230/50Hz = 230 Volt  
 277V = 277 Volt 60Hz  
 347V = 347 Volt 60Hz

#### ELECTRICAL OPTIONS

CO = Convenience Outlet\*  
 E = Emergency Ballast  
 EL = 20W, 35W\*\*\*\*  
 RFF = Radio Frequency Interference Filter  
 SW = Switch\*

- \*Fixture rated non-drip proof with CO or SW options
- \*\* 3-lamp version available in 17 watt only
- \*\*\* Electronic Ballast is standard on 17W, 35W, 50BX, 55BX
- ++ 35W not available in 50Hz
- \*\*\*\* Electronic Ballast optional for 20W and 35W

#### LENS OPTION

CP = Clear Polycarbonate Diffuser  
 (White translucent acrylic lens standard)

N-5610283D

# PHOENIX®