

PHOENIX®

INSTALLATION INSTRUCTIONS & REPAIR PARTS LIST FOR 1500 WATT "E" SERIES FLOODLIGHTS

Models MRSE1500A (Narrow Beam), MRSE1500B (Wide Beam), MRSE1500C (Very Narrow Beam) & MRSE1500D (Bat Wing Beam).

MOUNTING

NOTE: MOUNT FIXTURE TO NON-COMBUSTIBLE SURFACE ONLY

Fasten fixture with three or more one-half inch bolts through hole and slots in harp assembly. Use dimensions shown in Figure 1. Do not mount on unsupported cab or house roof. Attach near corner supports or use adequate subbase. Avoid boom mounting on light weight cross members which will vibrate or flex excessively. In addition to normal mounting (base down), fixture may be attached in a pendant or cantilever manner.

LAMPING (See "CAUTION" on page 4)

These fixtures are designed for 1500 watt BT-56 metal lamps when provided with a suitable remotely mounted ballast*. Lamping may be accomplished by removing the bottom socket housing. Loosen 1/4-20 x 1 screws which hold the socket housing in place. Rotate this housing and pull away from fixture.

When re-lamping, it is recommended that cover glass and reflector be cleaned to maintain fixture efficiency (see **CLEANING**, page 4).

CLEANING - LAMPING

1. Operate lamps ONLY with proper ballast.

CAUTION

2. In event of lamp failure, replace lamp or disconnect primary power to ballast within two weeks at the very most, otherwise permanent damage to electrical components from dielectric stresses may result from high voltage starting pulses.
3. Use protective gloves and protective eye equipment when replacing lamps.
4. If outer glass lamp bulb is broken, turn off lamp and replace it promptly to avoid exposure to ultraviolet energy. Even with lamp outer glass enclosure broken, the arc tube may continue to fire.
5. The arc tubes contain mercury. Use appropriate care in disposal of failed or broken lamps.

LAMP RECOMMENDATIONS

	Lamp Source & Type**
	Metal Halide (MH)
	Clear
ANSI Code No.	M48/U
Phoenix Part No.	4209600
SPECIFY VOLTAGE (Write for information on other than 60 HZ)	Available in the following voltages: Quad Volt (120/208/240/277) 60HZ 347 Volt 60HZ 480 Volt 60HZ

* Phoenix® Heavy Duty ballasts are recommended for optimum service and performance.

** Lamps carried in stock

REPAIR PARTS ILLUSTRATIONS

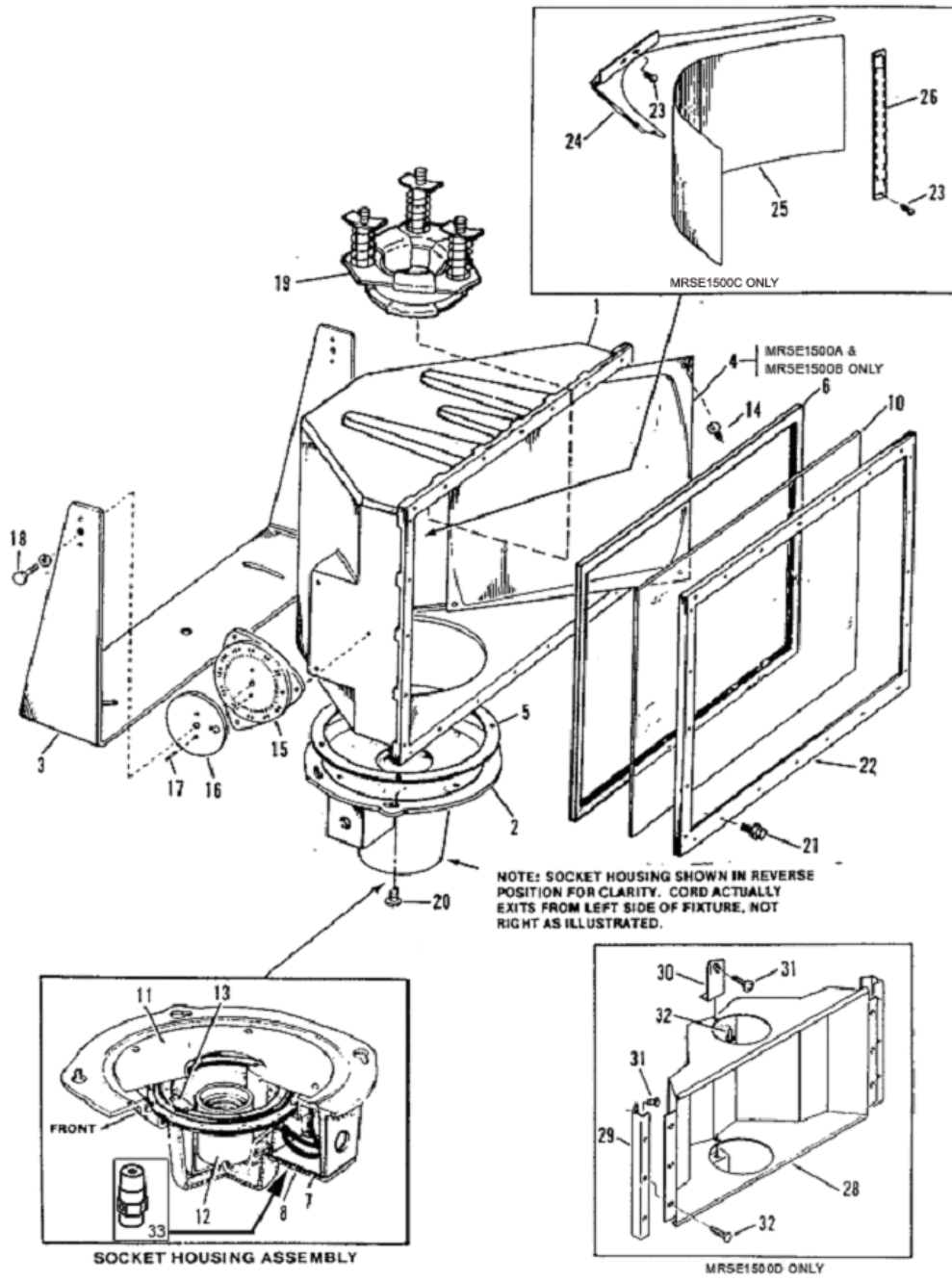

REPAIR PARTS LIST

ITEM	QTY	DESCRIPTION	PART NO.
1	1	Shell (MRSE1500C only) (All other MRSE1500 Series Models)	2204110 2204101
2	1	Socket Housing Assembly	1827507
3	1	Harp	1862970
4	2	Reflector Half (MRSE1500A only) (MRSE1500B only)	2647501 2647503
5	1	Port Gasket	5003000
6	1	Cover Glass Gasket	5002800
7	1	Splice Box Gasket	5002901
8	1	Splice Box Cover	2648650
10	1	Plain Cover Glass	4602400
11	1	Heat Shield	2648500
12	1	Lamp Socket	4502300
13	1	Socket Support Assembly (Including Diaphragm)	1630600
14	8	Phillips Pan Head Sems Machine Screw, 8-32 x 3/8	6002000
15	2	Hub Assembly	1821500
16	2	Washer	2646000
17			
18	2	S.S. Hex Head Cap Screw, 1/2-13 x 2	6033500
19	1	Lamp Retainer Assembly	1610900
20	4	S.S. Slotted Pan Head Machine Screws, 1/4-20 x 1	6003700
21	24	S.S. Hex Washer Head Type 25 Screw, No. 10 x 1	6020800
22	1	Cover Glass Retaining Strip Set	1055200
23	8	Pan Head Thread Forming Screw, 8 x 3/8 (MRSE1500C only)	6021000
24	2	Reflector Backup Plate Assembly w/Hardware (MRSE1500C only)	1071100
25	1	Reflector (MRSE1500C only)	2669300
26	2	Reflector Bracket (MRSE1500C only)	2307400
27	1	Instructions, Reflector Assembly (No Charge) (MRSE1500C only)	5475300
28	1	Reflector Assembly (MRSE1500D only)	1838300
29	2	Upper Bracket (MRSE1500D only)	2309900
30	2	Reflector Bracket (MRSE1500D only)	2310100
31	8	Round Head Machine Screw 6-32 x 3/8 (MRSE1500D only)	6002000
32	8	Sheet Metal Screw #8 x 3/8 (MRSE1500C only)	6021000
33	1	Breather Valve	7552980

**WHEN ORDERING:
SPECIFY PART NUMBER, DESCRIPTION, QUANTITY, AND MODEL NUMBER.**

AIMING

Aiming adjustments are made by loosening the harp and base fastening bolts and rotating the fixture and harp to the desired aim point. The fixture may be adjusted 360° in elevation and 22° in azimuth. Mounting locations should be established so as to position the fixture close to the desired azimuth aiming angle at installation. A gauge is provided on the side of the harp to aid in setting the desired elevation.

WIRING

The MRSE1500A, MRSE1500B, MRSE1500C, and MRSE1500D fixtures are furnished with a splice box supplied with a ½ inch NPT tapped hole for connecting the fixture to a suitable ballast. The green conductor is grounded to the fixture and must be connected to a positive ground. The other conductors are connected to the ballast according to the ballast wiring diagram. **DO NOT CONNECT GREEN (Ground) WIRE TO POWER SOURCE.**

Wiring connections must be made with metal conduit, flexible metal conduit, or flexible cord in compliance with the National Electrical Code.

CAUTION

All Wiring should be done by licensed electricians in accordance with State & Local Codes plus NEC (National Electrical Code) Standards.

Improper installation or use may result on serious injury.

CLEANING

If the interior surface of the cover glass or reflector surface becomes dirty it is recommended that they be cleaned to maintain maximum output. Ample access into the fixture exists when either the port cover or socket housing is removed. The glass may be cleaned with any non-abrasive conventional glass cleaner. The reflector should be cleaned with a soft cloth using soapy water or special reflector cleaners.

To prevent gaskets from sticking at sealing surfaces it is recommended that a liquid silicone release agent be lightly applied to gaskets when replacing any of the access covers. Best results are achieved when one application is wiped dry (to clean the gasket surface) and then a second application remains wet.

ONE YEAR PRODUCTS WARRANTY - (Limited Type)

Phoenix Products Company, Inc., warrants its products against defects in material and workmanship. Without charge, Phoenix Products Company will either repair or replace (Phoenix Products Company reserves the right to decide between repair or replacement) any properly installed Phoenix Products Company manufactured product which fails under normal operating conditions within one year from date of installation, provided it is returned to the factory (after authorization), transportation prepaid, and our inspection determines it to be defective under terms of this warranty.

The warranty covers only equipment manufactured by Phoenix Products Company and does not extend to transportation, installation, or replacement charges at buyer's facility; nor does it apply to any other equipment of another manufacturer used in conjunction with Phoenix Products Company equipment. No other warranty, expressed or implied, exists beyond that included in this statement.

PHOENIX PRODUCTS COMPANY, INC.

8711 West Port Avenue · Milwaukee, WI 53224 U.S.A.
Phone: 414.973.3300 ☎ Fax: 414.973.3210