

# PHOENIX<sup>®</sup>

## INSTALLATION INSTRUCTIONS & REPAIR PARTS LIST FOR 1000 WATT "E" SERIES FLOODLIGHTS

Hazardous Location Models MRSE1000A (Narrow Beam), MRSE1000B (Wide Beam), MRSE1000C (Very Narrow Beam) & MRSE1000D (Bat Wing Beam).

### MOUNTING

Fasten fixture with three or more one-half inch bolts through hole and slots in harp assembly. Use dimensions shown in Figure 1. Do not mount on unsupported cab or house roof. Attach near corner supports or use adequate sub-base. Avoid boom mounting on light weight cross members which will vibrate or flex excessively. In addition to normal mounting (base down), fixture may be attached in a pendant or cantilever manner.

### LAMPING (See "CAUTION" on page 4)

These fixtures are designed for 1000W Metal Halide and E-25 High Pressure Sodium lamps when provided with a suitable remotely mounted ballast\*. Lamping may be accomplished by removing the bottom socket housing. Loosen 1/4-20 x 1 screws which hold the socket housing in place. Rotate this housing and pull away from fixture.

When re-lamping, it is recommended that cover glass and reflector be cleaned to maintain fixture efficiency (see **CLEANING**, page 4).

### CLEANING - LAMPING

1. Operate lamps ONLY with proper ballast.

### CAUTION

2. In event of lamp failure, replace lamp or disconnect primary power to ballast within two weeks at the very most, otherwise permanent damage to electrical components from dielectric stresses may result from high voltage starting pulses unique to High Pressure Sodium circuits.
3. Use protective gloves and protective eye equipment when replacing lamps.
4. If outer glass lamp bulb is broken, turn off lamp and replace it promptly to avoid exposure to ultraviolet energy. Even with lamp outer glass enclosure broken, the arc tube may continue to fire.
5. The arc tubes contain mercury and/or sodium. Use appropriate care in disposal of failed or broken lamps.

### LAMP RECOMMENDATIONS

	Lamp Source & Type**		High Pressure Sodium (HPS)
	Metal Halide (MH)†		
	Clear	Coated	
ANSI Code No.	M47PA-R1000/U	M47PB-R1000/U	S52XB-1000
Phoenix Part No.	4209600	4210300	420900
BALLAST REQUIRED*	Refer to literature #N5610012		
SPECIFY VOLTAGE (Write for information on other than 60 HZ)	Available in following voltages: Quad Volt (120 / 208 / 240 / 277) 60Hz -480 Volt 60Hz		

\* Phoenix<sup>®</sup> Heavy Duty ballasts are recommended for optimum service and performance.

\*\* Lamps carried in stock

† Metal Halide is sometimes referred to as "Multi-Vapor."

### CAUTION

Ballasts are not interchangeable between lamp types (MV / MH / HPS).

\*\*SPECIAL HPS NOTE: As a general rule, the maximum recommended distances for remote mounting High Pressure Sodium ballasts is 35 feet for voltage stabilized types and 5 feet for lag types. Refer to the particular ballast manufacturer's recommendation when installing ballasts.  
(See page 4 for additional instructions)

# REPAIR PARTS ILLUSTRATIONS

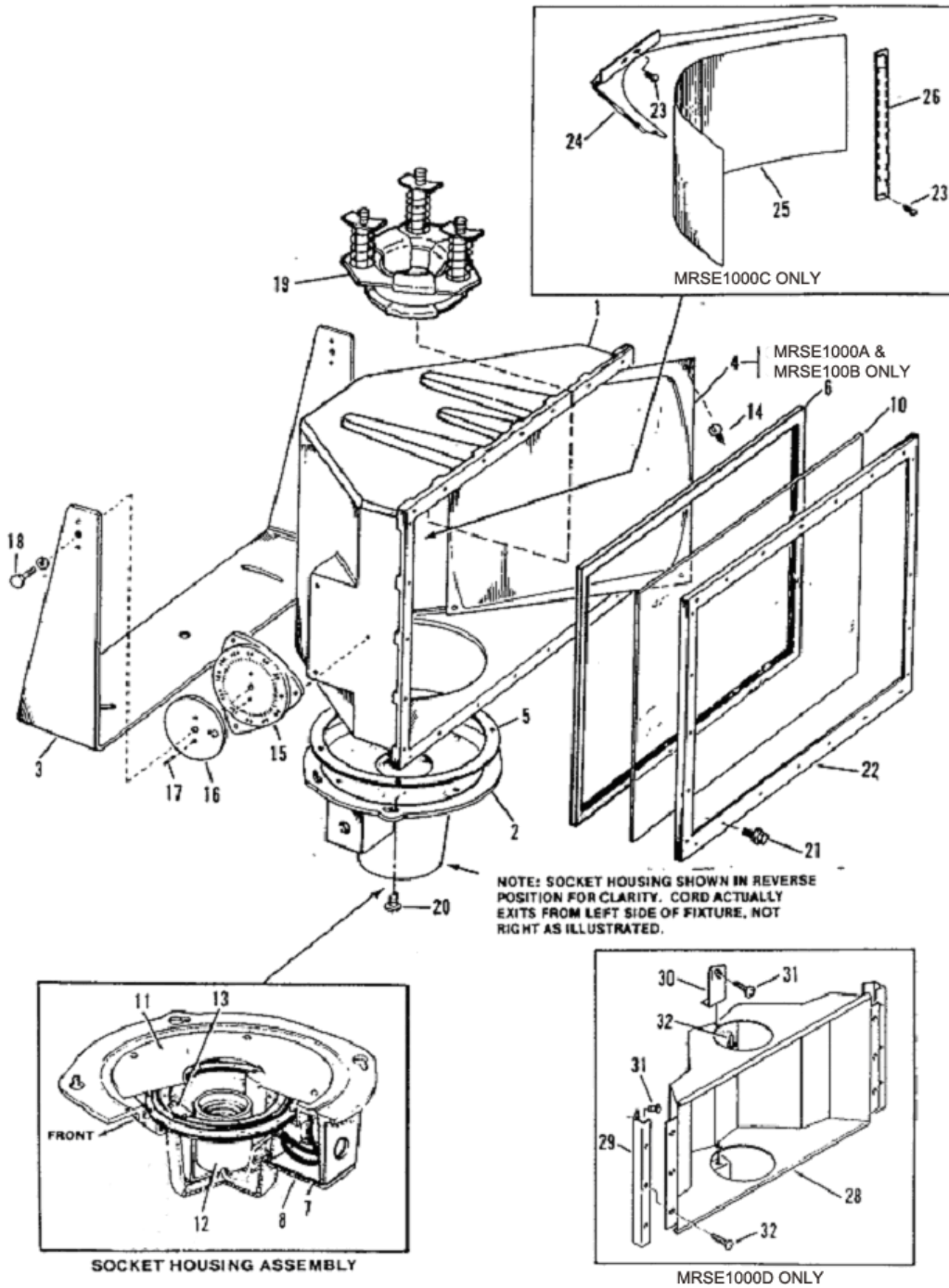

# REPAIR PARTS LIST

ITEM	QTY	DESCRIPTION	PART NO.
1	1	Shell (MRSE1000C only) (All other MRSE1000 Series Models)	2204110 2204101
2	1	Socket Housing Assembly	1827501
3	1	Harp	1862970
4	2	Reflector Half (MRSE1000A only) (MRSE1000B only)	2647501 2647503
5	1	Port Gasket	5003000
6	1	Cover Glass Gasket	5002800
7	1	Splice Box Gasket	5002900
8	1	Splice Box Cover	2648600
10	1	Plain Cover Glass	4602400
11	1	Heat Shield	2648500
12	1	Lamp Socket	4502300
13	1	Socket Support Assembly (Including Diaphragm)	1630600
14	8	Phillips Pan Head Sems Machine Screw, 8-32 x 3/8	6002000
15	2	Hub Assembly	1821500
16	2	Washer	2646000
17			
18	2	S.S. Hex Head Cap Screw, 1/2-13 x 2	6033500
19	1	Lamp Retainer Assembly	1610900
20	4	S.S. Slotted Pan Head Machine Screws, 1/4-20 x 1	6003700
21	24	S.S. Hex Washer Head Type 25 Screw, No. 10 x 1	6020800
22	1	Cover Glass Retaining Strip Set	1055200
23	8	Pan Head Thread Forming Screw, 8 x 3/8 (MRSE1000C only)	6021000
24	2	Reflector Backup Plate Assembly w/Hardware (MRSE1000C only)	1071100
25	1	Reflector (MRSE1000C only)	2669300
26	2	Reflector Bracket (MRSE1000C only)	2307400
27	1	Instructions, Reflector Assembly (No Charge) (MRSE1000C only)	5475300
28	1	Reflector Assembly (MRSE1000D only)	1838300
29	2	Upper Bracket (MRS-ED-1000H only)	2309900
30	2	Reflector Bracket (MRSE1000D only)	2310100
31	8	Round Head Machine Screw 6-32 x 3/8 (MRSE1000D only)	6002000
32	8	Sheet Metal Screw #8 x 3/8 (MRSE1000C only)	6021000

**WHEN ORDERING:  
SPECIFY PART NUMBER, DESCRIPTION, QUANTITY, AND MODEL NUMBER.**

## AIMING

Aiming adjustments are made by loosening the harp and base fastening bolts and rotating the fixture and harp to the desired aim point. The fixture may be adjusted 360° in elevation and 22° in azimuth. Mounting locations should be established so as to position the fixture close to the desired azimuth aiming angle at installation. A gauge is provided on the side of the harp to aid in setting the desired elevation.

## WIRING

The MRSE1000A, MRSE1000B, MRSE1000C, and MRSE1000D fixtures are furnished with a splice box supplied with a ½ inch NPT tapped hole for connecting the fixture to a suitable ballast. The green conductor is grounded to the fixture and must be connected to a positive ground. The other conductors are connected to the ballast according to the ballast wiring diagram. **DO NOT CONNECT GREEN (Ground) WIRE TO POWER SOURCE.**

Wiring connections must be made with metal conduit, flexible metal conduit, or flexible cord in compliance with Class 1, Div. 2

**CAUTION**

Wiring Methods defined in the National Electrical Code. **All Wiring should be done by licensed electricians in accordance with State & Local Codes plus NEC (National Electrical Code) Standards.**

**Improper installation or use may result in serious injury.**

## ONE YEAR PRODUCTS WARRANTY - (Limited Type)

Phoenix Products Company, Inc., warrants its products against defects in material and workmanship. Without charge, Phoenix Products Company will either repair or replace (Phoenix Products Company reserves the right to decide between repair or replacement) any properly installed Phoenix Products Company manufactured product which fails under normal operating conditions within one year from date of installation, provided it is returned to the factory (after authorization), transportation prepaid, and our inspection determines it to be defective under terms of this warranty.

The warranty covers only equipment manufactured by Phoenix Products Company and does not extend to transportation, installation, or replacement charges at buyer's facility; nor does it apply to any other equipment of another manufacturer used in conjunction with Phoenix Products Company equipment. No other warranty, expressed or implied, exists beyond that included in this statement.

**PHOENIX PRODUCTS COMPANY, INC.**  
8711 West Port Avenue · Milwaukee, WI 53224 U.S.A.  
Phone: 414.973.3300 ☎ Fax: 414.973.3210

When the fixture is installed in a Class 1, Div. 2 Hazardous Location, strict compliance to the fixture warning label instructions must be met.

WARNING:		AVERTISSEMENT:	
TO PREVENT FIRE OR EXPLOSION DO NOT INSTALL WHERE MARKED OPERATING TEMPERATURE EXCEEDS THE IGNITION TEMPERATURE OF HAZARDOUS ATMOSPHERES.		POUR EVITER LES RISQUES D'INCENDIE OU D'EXPLOSION, NE PAS INSTALLER DANS UN ENLACEMENT OÙ LA TEMPÉRATURE D'ENFLAMMATION DES GAZ AMBIANTS EST INFÉRIEURE À LA TEMPÉRATURE DE SERVICE NOMINALE.	
MAXIMUM OPERATING TEMPERATURES			
°C (°F)		LAMP TYPE	
260 (500)	250 WATT TYPE S50	HIGH PRESS. SODIUM, COATED.	
325 (617)	400 WATT TYPE S51	HIGH PRESS. SODIUM, COATED.	
350 (662)	250 WATT TYPE S50	HIGH PRESS. SODIUM, CLEAR.	
350 (662)	400 WATT TYPE M59	METAL HALIDE, CLEAR OR COATED.	
350 (662)	400 WATT TYPE H33	MERCURY VAPOR, CLEAR.	
350 (662)	400 WATT TYPE H33	MERCURY VAPOR, COATED.	
450 (842)	400 WATT TYPE S51	HIGH PRESS. SODIUM, CLEAR.	
CAUTION:		ATTENTION:	
USE ONLY WITH SUITABLE CERTIFIED BALLAST PER INSTRUCTION N5610012		UTILISER SEULEMENT AVEC UN BALLAST CERTIFIÉ CONFORME À LA NOTICE N5610012	

## CLEANING

If the interior surface of the cover glass or reflector surface becomes dirty it is recommended that they be cleaned to maintain maximum output. Ample access into the fixture exists when either the port cover or socket housing is removed. The glass may be cleaned with any non-abrasive conventional glass cleaner. The reflector should be cleaned with a soft cloth using soapy water or special reflector cleaners.

To prevent gaskets from sticking at sealing surfaces it is recommended that a liquid silicone release agent be lightly applied to gaskets when replacing any of the access covers. Best results are achieved when one application is wiped dry (to clean the gasket surface) and then a second application remains wet.

**NOTE: A similar fixture @ 400 watts is also available. Write for information on MRSE400 Series**