

EPIC - Pole Mount

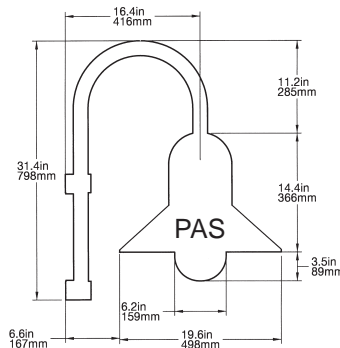

Dome Top

Cone Top

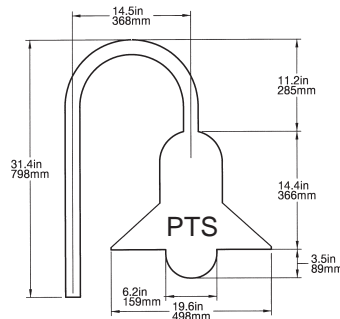
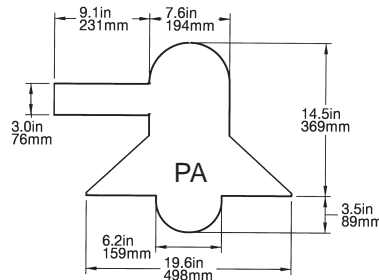

General: The classic contemporary style of the Epic blends well into a variety of architectural styles—past and present.

Construction: Cast marine-grade, low-copper content aluminum top, housing, shade, and mounting gear. Stainless steel external hardware to protect against corrosion.

Lens: Opal glass globe is standard. Clear glass globe available.

Lamps: HID and fluorescent lamps included. Accepts up to 175W PSMH and 150W HPS lamps, 26-42W compact fluorescent lamps, 150W (max.) incandescent lamps, and 55W and 85W induction lamp systems.

Ballast: Integral ballast for easy access and maintenance. Dual volt (120/277V) 60Hz ballast standard with 50W HID units; 70W-175W units standard with quad volt (120/208/240/277V) 60Hz ballast; compact fluorescent units standard with universal 120-277V 50/60Hz electronic ballast; induction lamp units provided with 100-120V, 200-277V 60Hz ballast.

Tops: Two top styles available: cone (straight arm only) and dome.

Mounting: Three pole mount styles available: straight arm, shepherd's crook, and shepherd's crook post top. See order information for quantity and configuration details.

Pole: Sold separately. See Phoenix "Pole Specification Guide".

Finish: Textured polyester powder coat finish. Shade underside is standard with white finish. Black, bronze, gray, white, silver, and verde green options available. For custom colors, please contact factory.

Gaskets: EPDM gaskets standard.

EPA and Weight: EPA: PA=0.69ft², PAS=0.88ft², PTS=0.86ft²; weight: PA=26lbs, PAS=27lbs, PTS=26lbs.

Listings: UL Listed 1598 for Wet Locations. Indoor/Outdoor listed for use in Canada.

WALL MOUNT FIXTURE AVAILABLE



PHOTOMETRICS

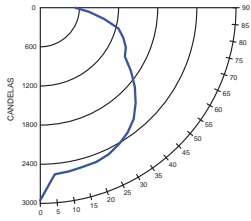

ECPA150PSMH*
 150W Medium Base PSMH
 NEMA Type: 7x7
 Lumens - 12900
 * Insert Top Style

ORDERING INFORMATION

Example	SERIES	MOUNT	WATT/ TYPE	TOP STYLE	OPTIONS		
					LENS (opal standard)	VOLTAGE (277V standard)	FINISH
	EC	PA	100MH	C	CL	347V	BRZ
	EC	PA PAS PTS	50MH 70MH 100MH 150PSMH 175PSMH 50HPS 70HPS 100HPS 150HPS INC 26CFL 32CFL 42CFL 55IL 85IL	C D	CL	220/240-50H 347V	BLK BRZ WHT VGN GRY SIL CC

Lamp Wattage/Type (Lamp Included)

- 50MH = 50W Metal Halide (ED17)
- 70MH = 70W Metal Halide (ED17)
- 100MH = 100W Metal Halide (ED17)
- 150PSMH = 150W Pulse Start Metal Halide (ED17)
- 175PSMH = 175W Pulse Start Metal Halide (ED17)
- 50HPS = 50W High Pressure Sodium (ED17)
- 70HPS = 70W High Pressure Sodium (ED17)
- 100HPS = 100W High Pressure Sodium (ED17)
- 150HPS = 150W High Pressure Sodium (ED17)
- INC = Incandescent (150W max.)
- 26CFL = 26W Compact Fluorescent
- 32CFL = 32W Compact Fluorescent
- 42CFL = 42W Compact Fluorescent
- 55IL = 55W Induction Lamp System
- 85IL = 85W Induction Lamp System

Mounting

- PA = Straight Arm Pole Mount
- PAS = Shepherd's Crook Pole Mount
- PTS = Shepherd's Crook Pole Mount - Single post top mount

Top Style

- C = Cone Top (n/a with Shepherd's Crook mounting styles)
- D = Dome Top

Lens (Opal Glass Standard)

- CL = Clear Glass Globe

Voltage

- HID: 50W = 120/277V; 60 Hz standard
- 70W+ = 120/208/240/277V 60 Hz standard
- CFL: 120-277V; 50/60 Hz standard
- IL: 100-120V; 200-277V 60 Hz only
- 220/240-50H = 220/240V, 50Hz (HID units only)
- 347V = 347 Volt (70W HID or higher units only)

Finish

- BLK = Black
- BRZ = Bronze
- WHT = White
- VGN = Verde Green
- GRY = Gray
- SIL = Silver
- CC = Custom Colors (contact factory)

N5610342C

